

HSF RoHS

REV	ECN NO	DESCRIPTION	DATE	NAME
A		NEW		

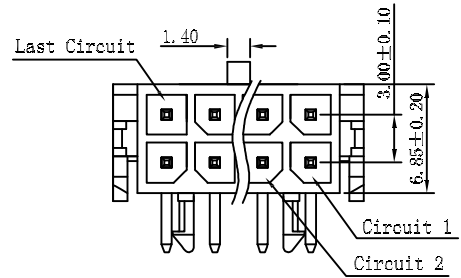

Note:

- Material
 - Housing: NY66, Color:Black
 - Contact: Brass,Tin.
- Rating:
 - Operating Voltage: 250V AC/DC.
 - Current Rating: 5A AC/DC.
 - Operating Temperature: -25°C~+85°C.
 - Contact Resistance:30 mΩ max.
 - Insulation Resistance:1000 MΩ min.
 - Dielectric withstanding Voltage: AC 1500V

Pin NO.	Dimensions (mm)	
	A	B
02	---	6.65
04	3.00	9.65
06	6.00	12.65
08	9.00	15.65
10	12.00	18.65
12	15.00	21.65
14	18.00	24.65
16	21.00	27.65
18	24.00	30.65
20	27.00	33.65
22	30.00	36.65
24	33.00	39.65

3.Pater Number:

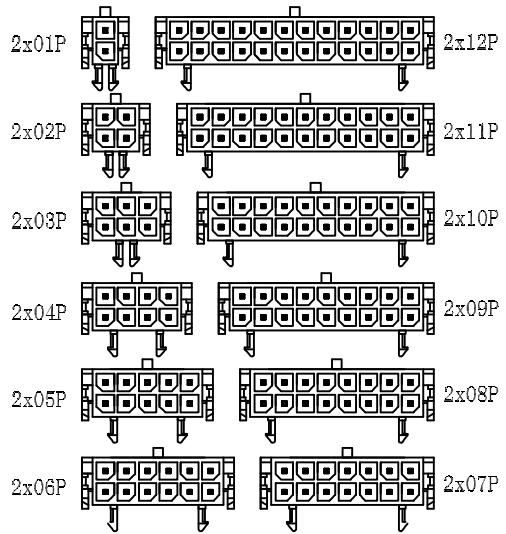

Ordering Information

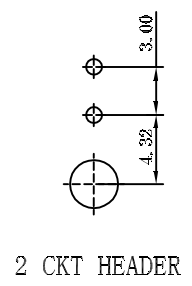
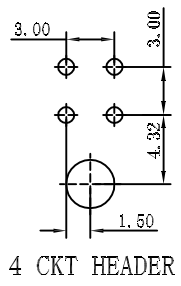
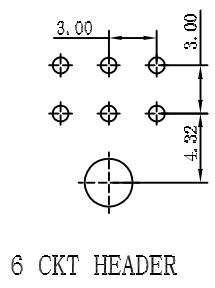
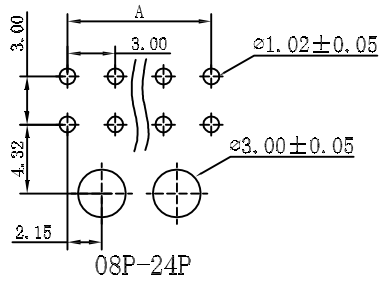
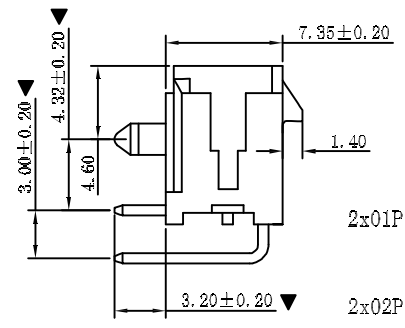
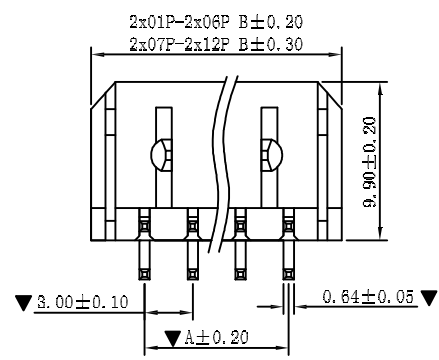
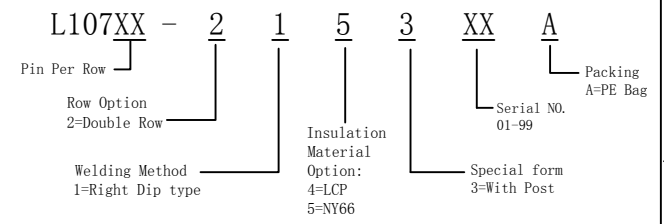

P. C. B. LAYOUT

CIRCUIT SIZE LAYOUT

LDCONN 东莞连大精密制品有限公司
 连大 DongGuan LianDa Precision Products Co., LTD

TITLE	PH3.0mm Wafer Double row, Right DIP type	DRAWN BY	WZG	17.03.30
PART NO	L107XX-2153XXA	CHECKED BY		
DRAWING NO		APPROVED BY		

SCALE 1:1 UNIT mm PAGE 1/1 SIZE A4

STANDARD TOLERANCE (EXCEPT SPECIFIED)	
LINER	ANGLES
.0 ±0.30	0.° ±3°
.00 ±0.20	.0° ±2°
.000 ±0.10	.00° ±1°